

<http://stuffboston.com/good/archive/2010/04/05/model-living.aspx>

Model Living

by [Erin T. Gates](#) | April 05, 2010



The bustling streets of Downtown Crossing have long been a popular place to work and shop, but rarely an area synonymous with luxury living. Yet the incredibly convenient location at the crossroads of Back Bay, Beacon Hill, the Financial District, and Government Center should make it a hotbed for downtown professionals who want to live a stone's throw from everything Boston has to offer. Lucky for us, the opening of the brand-new residences at **45 Province** provides a magnificent place to call home in the heart of the action. The 32-story glass-and-brick building, designed by Bruner/Cott & Associates, houses 138 units, varying from one to three bedrooms and ranging in price from \$600,000 to \$5.5 million. The developers of the project

partnered with some of Boston's biggest names in interior design to not only outfit the public spaces, but create model units worthy of magazine spreads.

Celeste Cooper, who has designed so many of Boston's most adored spaces, such as XV Beacon Hotel and Mistral, was the creative force behind the open, light-filled lobby. "I believe our design team has put together a vibrant take on the 'new Boston,'" Cooper says. "Our design is clean and spare, but warm and inviting - timeless for the 21st century. It is urban living at its most urbane." As you move into the interior spaces, you'll find textural woven wall coverings, welcoming walnut front doors, and furniture by local designer Dennis Duffy's line D Scale.

Duffy also designed one of the two-level model units, an airy one bedroom plus office with a soaring wall of glass sure to cause jaws to drop. Outfitted in sleek modern furnishings, the space exudes minimalist appeal and showcases the floor plan's flexibility. As in all of the units, there are top-of-the-line finishes such as lacquered European cabinetry, stone and glass tiles, Sub-Zero and Bosch appliances, and bamboo flooring. On another floor, designer Manuel de Santaren created a warm and layered space in a unit with a vastly different one-level floor plan. Magnificent pocket doors section off a cozy chocolate-walled office from the living room, which leads to a bedroom bathed in soft blues reminiscent of the ocean you can spy from the window.

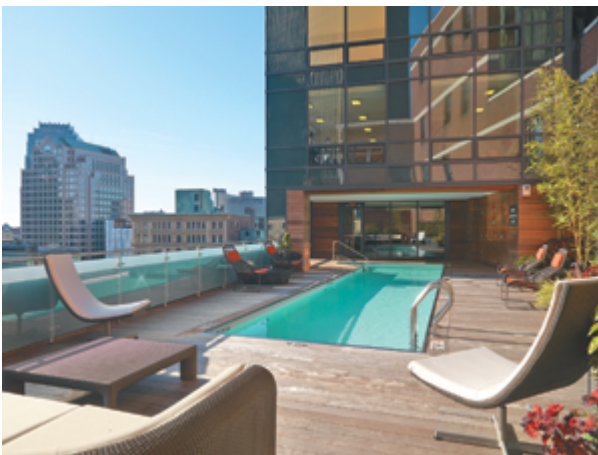

When not enjoying these deliciously designed spaces, residents can entertain and relax in the many public areas available to them. The parlor comes complete with a catering kitchen, a dining area, and a lounge area featuring a fireplace and daily complimentary continental breakfast (for those mornings when you can't bear to even make your own toast). Across the hall

from that space is a comfortable screening room that can be rented out for private viewing parties and big games. And to top it off, there's the Exhale Spa gym and indoor/outdoor private pool facility, where you can take an exercise class or get a spa treatment by staff members from Exhale's popular Arlington Street location.

With the luxurious amenities of the best hotels but the warmth of a home, the units at 45 Province are some of the most appealing new residential spaces in Boston. And for design buffs who covet the work of our city's hottest talent, the fact that such varied styles and visions can be found in one building is certainly something to write home about. Or better yet, a fabulous place to *call* home.